

SITE PLAN

TOTAL SITE AREA: 9.54 ACRES (415,433 SF)

TOTAL BUILDING AREA: 138,700 SF

SITE COVERAGE: 33.4%

TOTAL CAR PARKS: 146 SPACES (1.05 / 1000 SF)

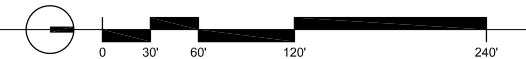
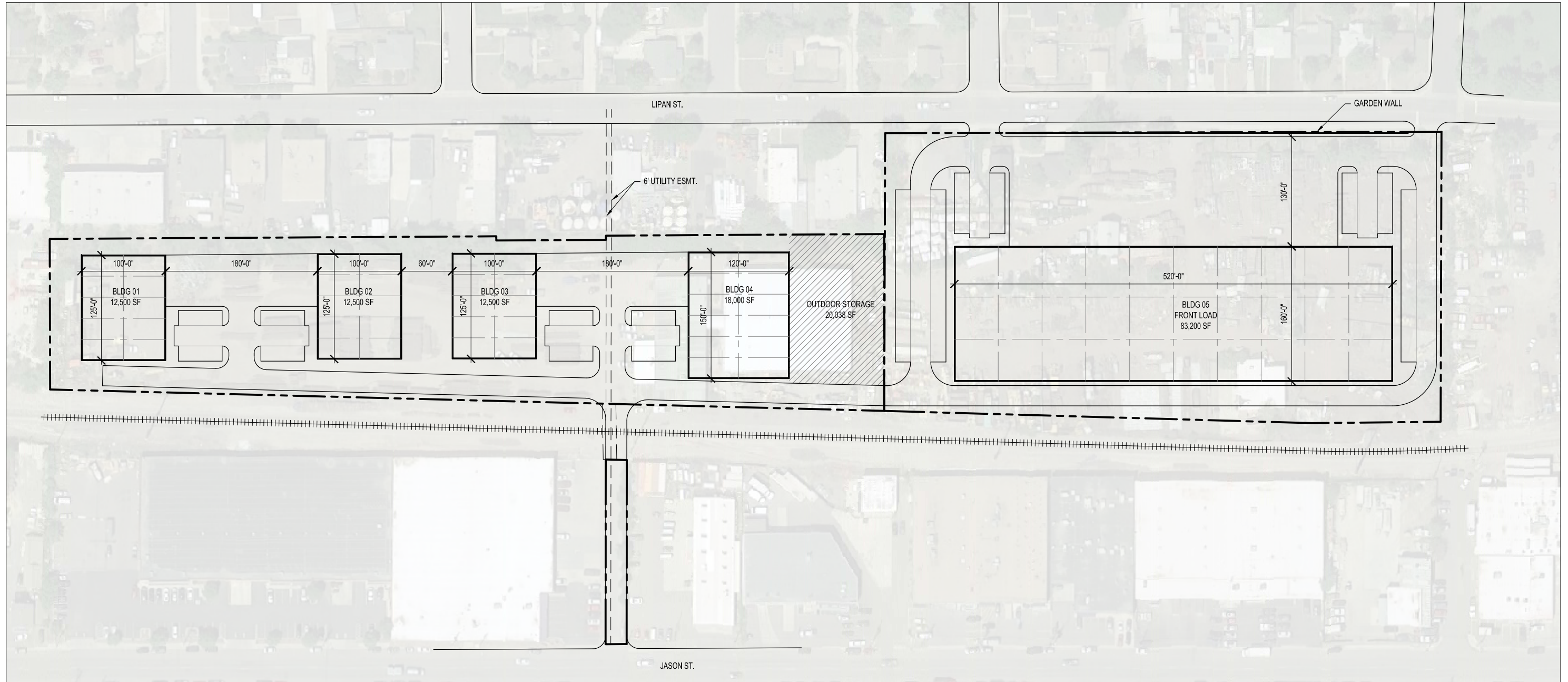

JASON & LIPAN ST.
a project for
JLL

DENVER

19 JULY 2019

COLORADO

194059

powers
brown
archit
ecture

SITE PLAN - OPT. 02

TOTAL SITE AREA: 9.54 ACRES (415,433 SF)

TOTAL BUILDING AREA: 139,100 SF

SITE COVERAGE: 33.5%

TOTAL CAR PARKS: 134 SPACES (0.96 / 1000 SF)

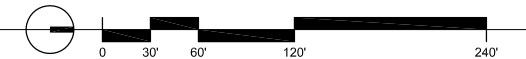
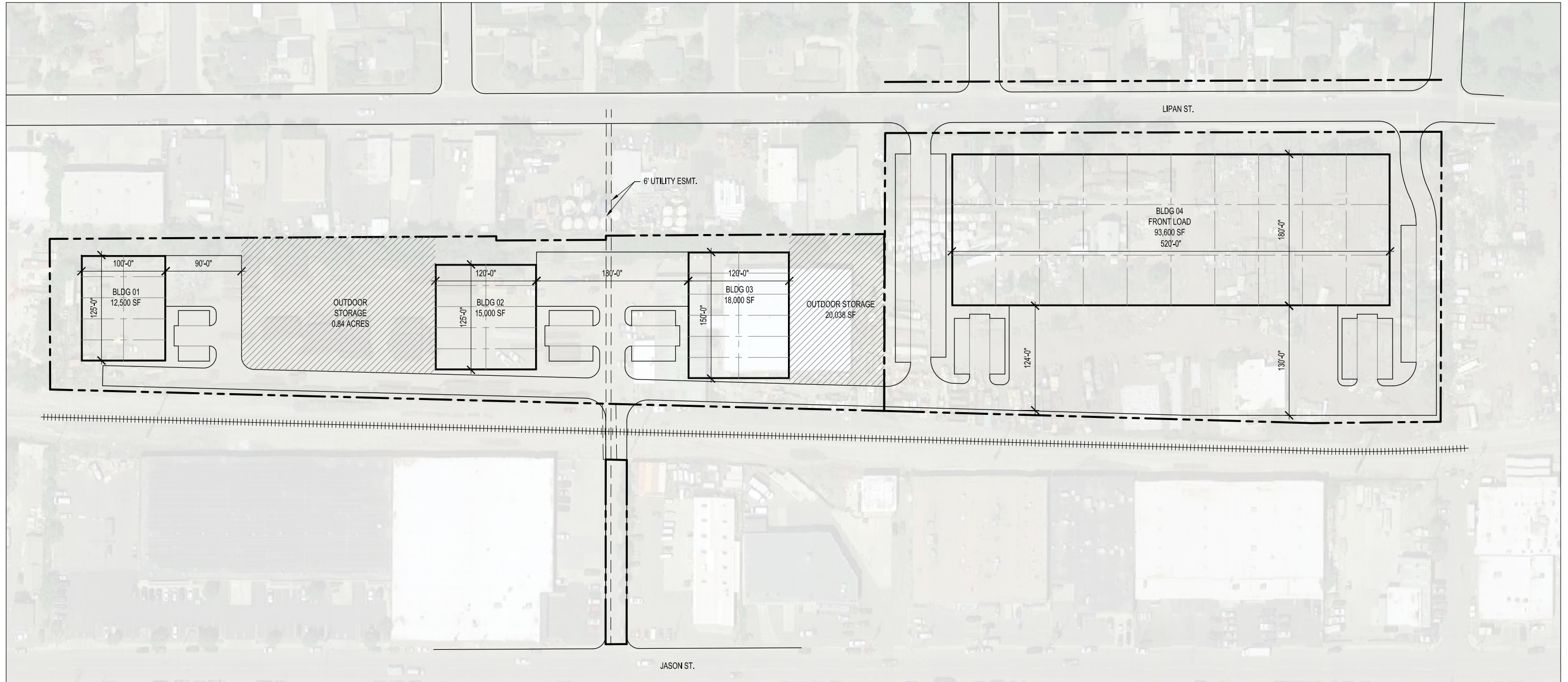

JASON & LIPAN ST.
a project for
JLL

DENVER

24 JULY 2019

COLORADO

194059

powers
brown
archit
ecture